

PARD NV007SP Manual

Shenzhen Pard Technology Co.,Ltd

Important note

1. Don't look directly at the IR infrared light, or it will cause your eye damage!
2. This product's infrared light will focus on a lot of energy in the open state, do not aim at flammable objects at close range, otherwise it may cause fire. When not in use, please close the IR infrared light, or enter in sleep mode!
3. This product needs to be adapted with a focusing function optical telescope (with AO focus or side focus), otherwise it may not be available!
4. A few optical telescopes may not be able to match this product because of the design of the optical path.

PARD Night Vision NV007SP



Operation Manual

—1—





—4—

Turn on the power. After starting up, adjust diopter first.

First, turn eyepiece dioptic adjustment ring till characters appeared become sharp in the screen. (This process does not need to go with a clear image in your view.)

Second, turn the objective lens focusing adjustment ring until a clear cross curve appears in the center of the screen.

Thirdly, (do sleeve installation as later described in next section) have the sleeve lock switch locked.

Turn the focusing ring of the attached telescope till the view become clear.

3.Sleeve installation

1.Put the eye piece of the selected telescope into the sleeve until the sleeve reaches the bottom of the telescope. Adjust connection angel if necessary and tighten the fastening screw for a stable connection.

(The attached sleeve applies to any eyepieces with the length within <45mm, if longer than this length please use insulated rubber tape wrap and fix it.)

—6—

Unpacking

This box contains a night vision optics with,

- | | |
|---------------------|---------------------|
| 1 sleeve; | 1 data cable; |
| 2 hexagon wrenches; | 1 software package. |

Storage card is not included. Please prepare a TF card (128g maximum) for data storage.

Installation

1.Battery installation

Please use 3.7V Lithium chargeable 3.7V flat battery 18650.Remove battery compartment cap and make sure setting the thepositive polar towards to the direction inward. Put the cap back and screw it until tight. (Fail to do so may result in restarting!).

2.Adjustments

—5—

2.Connect the optics with the sleeve by aim the salient point on the sleeve base to the groove of the sleeve, then push and turn until hear the sound of clicking.

3.Whereas, move the sleeve lock switch to the rear and turn this device a little bit can separate this device and the sleeve.

Instructions

1.Turn On/Off :

Press and hold the power button (about 1 second) to turn on/off.The power indicator light will be on/off.

2.Sleep / Wake-up mode :

In the state of power-on, repeatedly press sleep/wake-up button may successively enter into sleep mode / wake-up mode in turn, the power indicator light is normally on in the sleep mode.

—7—

3.The eyepiece adjustment

Eyepiece focusing or dioptic adjustment is designed to help users with different visions see a clear view. Just one time tuning is needed for an eye of one certain user. Please turn the eyepiece dioptic adjustment ring till characters appeared in the screen become sharp.

(Please note the image obtained now may be breezing before doing objective lens adjustments.)

4.The objective lens focusing

Please finish eyepiece adjustment before doing the objective lens adjustment. Aim at your target, turn objective lens ring until you've achieved an stable and well focused image.

In general, set the position of OA to the point of infinity

5.IR fill light brilliance control

—8—

1>Center Position Adjustment

Press the "OK" button to enter the sub-page, press "+" or "-" to adjust the Y value; press the IR menu button to adjust the X value to adjust the sub-line in the optical telescope to the center of the display. Press "OK" to save and exit.

2>Default Color

Press "+/-" button repeatedly and select "Color" in roll-up menu. Press "OK" to enter setting.

Press "+/-" repeatedly to select color or BW mode in turn. Press "OK" to set.

3>Brilliance control

Select "IR brilliance control" and press "OK" to enter. Press "+/-" repeatedly to make switch among "off, 1,2,3". Press "OK" to set.

Please note that the setting you've made will only take effect in your next starting up. **This is Not for your instant setting.**

—10—

In black and white mode, repeatedly press the IR fill light brilliance control button to adjust IR light brilliance among range of 3 gears(set IR1-3 or off). The fill light is also stretchable so that it can be pulled and pushed to fill light.

6.Laser ranging

press and hold zoom in/red laser switch button to turn on/off laser ranging.

7.Menu operation

Press Menu button to call out menu. Press +/- button to select each sub-menu. Press OK/photo/ recording to enter the settings.

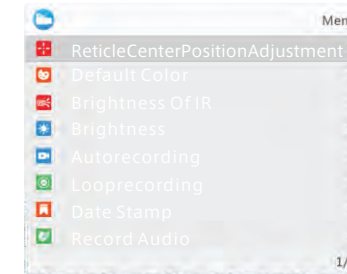

—9—

Please enter into BW mode and press "IR fill light brilliance control" button for instant brilliance control.

4>Auto Recording

Select "Auto Recording" and press "OK" for auto recording setting. Select "on" or "off". This setting determines auto recording is on or not in your next starting up.

5>Circulating recording

Select "Circulating recording" and press "OK" for circulating recording setting. Select "off", "1min", "3 min", "5 min" or "10 min". Press "OK" to confirm. This setting determines circulating recording is on or not in your next starting up.

6>Time stamp

Select "Time stamp" and press "OK" for time stamp setting. Select "on" or "of". Press "OK" to confirm. This determines time stamp is set or not when recording.

—11—

7>Audio synchronization

Select "Synchronized audio video" and press "OK" . Select "on" or "off". Press "OK" to confirm. This allows audio synchronization when recording.

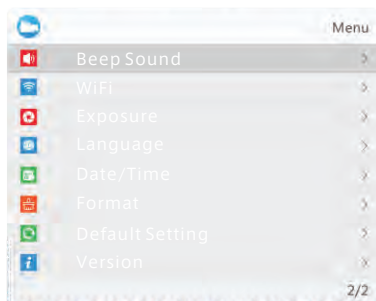

8>Keyboard press sound

Select "Keyboard press sound" and press "OK"for keyboard press setting. Select "on" or "off". Press "OK" to confirm. This setting allows keyboard press sound is also recorded when making recordings.

—12—

Select "Date/Time"and press "OK" to set up date and time.Select respectively "Year", "Month", "date", "Hour". "Minute" and "Second",and press "+/-" for designated value. Press "OK" to save change.

Also select "Date display format", press"+/-" for preferred date display format among "YY/MM/DD"" MM/DD/YY""DD/MM/YY".

13>Formatting

Select "Formatting"and press "OK"for formatting setting. When tend to apply operation system will prompts "all data will be erased!" Please take extreme caution to perform this operation. All data could not be restored if formatted.

14>Factory setting

Select "Factory setting" and press "OK" for factory setting. Select "OK"or "Cancel"to restore factory setting or not. Please take extreme caution to perform this setting.

—14—

9>WiFi

Select "WiFi"and press "OK" for WiFi setting. Select "on" or "off"to turn on / off WiFi. Please note you cannot call out menu when WiFi is On. Press and hold"WiFi" button.

10>Exposure compensation

Select "Exposure compensation"and press "OK"for exposure compensation setting. Options "+2/3", "+1/3", "+0.0", "-1/3"are available.

11>Languages

Select "language setting"and press"OK" for language setting. Options include"English""Francais""Espanol""Portugurs""Deutsch""Italino""Pyccknn"and"日本語""Cesky".Choose your preferred language for your system.

12>Date/Time

—13—

8.Shortcuts

On the user interface,
press and hold IR fill light brilliance control / Color or BW mode button to make switch between color / BW mode;
Press and hold WiFi button to turn on/off WiFi;

Press playback button to playback video clips stored in SD card;
Press OK/photo/recording button to make photo and video recording mode switch;

Press - to zoom in or zoom out.Press + to turn on/off Red dot indication.

—15—

Specifications

Model No.	NV 007S	Battery	18650x1	Dimension	102*75*118
Magnifying power	4x-14x	IR wave length	850/940nm	IR power	5w
Photo resolution	2592*1944	Storage type	T F Card	Battery life	> 8h
Sleeve size	< 45mm	Focusing	3cm-∞	Transmission method	WiFi
Video resolution	1920*1080	Weight	265g	IR illuminate distance	200m
Eyepiece resolution	1024*768	Frame rate	30fps	Output type	AVI
Voltage	3.7V				

—16—

Warranty

This product is warranted against defects in materials and workmanship for a period of one year from the date of purchase.

This warranty is for the original purchaser only!

Notice :

Operate this device in daylight or view any strong radiation source like the Sun, electric welding and Laser directly may cause permanent damage to internal parts of this device and this is not covered by the Warranty.

The right to interpret this manual is owned by PARD.

Product specifications are subject to change without notice.

—18—

Warranty card

Product model:

Product code:

Date of purchase:

Warranty period:

User Name:

User's phone:

User address:

Warranty records:

—17—

This device complies with Part 15 of the FCC Rules. Operation is subject to the following two conditions: (1) this device may not cause harmful interference, and (2) this device must accept any interference received, including interference that may cause undesired operation

NOTE: This equipment has been tested and found to comply with the limits for a Class B digital device, pursuant to Part 15 of the FCC Rules. These limits are designed to provide reasonable protection against harmful interference in a residential installation. This equipment generates, uses and can radiate radio frequency energy and, if not installed and used in accordance with the instructions, may cause harmful interference to radio communications. However, there is no guarantee that interference will not occur in a particular installation.

If this equipment does cause harmful interference to radio or television reception, which can be determined by turning the equipment off and on, the user is encouraged to try to correct the interference by one or more of the following measures:

- Reorient or relocate the receiving antenna.
- Increase the separation between the equipment and receiver.
- Connect the equipment into an outlet on a circuit different from that to which the receiver is connected.
- Consult the dealer or an experienced radio/TV technician for help.

Warning: changes or modifications not expressly approved by the party responsible for compliance could void the user's authority to operate the equipment

The device has been evaluated to meet general RF exposure requirement , the device can be used in portable exposure condition without restriction

Additional Product Information

For

PARD 007SP and 007SP-LRF



Updated 31st Jan 2023, Applies to the Australian &
New Zealand Market.

Important

- This device contains a visible laser and a laser IR Emitter (the IR Light). Because of the potential risk to your eyes vision do NOT look directly at either of these light sources, or point them towards other people, pets, and reflective objects.
- Keep the IR light away from flammable objects, otherwise it may cause a fire.
- Turn off the IR light or use sleep mode when you are not actively using the device.
- **When fitting the device to your scope, treat it like a camera, be gentle, always PULL Pin clip back when attaching and releasing it from your scope.**
- Don't remove the battery while the unit is switched on, even in sleep mode as this may cause the device to fail to start up or function abnormally. You may need to reinstall the software to correct this (It is very rare, but can happen).
- Always remove the Battery from the device for charging and only use a quality charging device and batteries.
 - These devices use 18650 FLAT TOP batteries.
 - Remove the battery when the device is not being used (Storage).
- DO NOT power the unit from an external USB Battery source.
- **Never point the device at strong sources of light, such as the sun, welding or a laser; damaged caused by such will void the warranty.**
- If you have questions please contact us; information online around the world are often incorrect or outdated and its best to get the correct information from us.

We highly recommend that you watch our videos online at pardaustalia.com.au

Parallax on your Riflescope

Ideally this device requires rifle scopes that have parallax controls to obtain both the best imaging and the best accuracy. This is because if your scope is not in parallax, you could be potentially 'aiming' the scope just the same as you can with your head.

For scopes without parallax, ensure that the device is mounted centrally to the scope as practicable. If your scope does not have parallax you should test the accuracy before hunting.

You are able to focus the 007 more on the image than the reticle to make it better, we have a video here showing this on our FAQ Page.

Videos

We have made a video of setting up a 007.

All our videos are taken in Australia or New Zealand, they show the real-world results that can be achieved with the PARD. Visit pardaustalia.com.au and look for 'How to videos'.

Support

If you have any questions or issues with your device, please contact us via the pardaustalia.com.au website.

Some variations may exist due to variations in the firmware.

Support is available Monday to Friday 9-5; after hours please email, web chat or text first.

This manual is for Australia & New Zealand Only

Warranty

In Australia & New Zealand this device is warranted against defects in materials and workmanship for a period of two years from the date of purchase. This applies to the original purchaser only.

Battery Installation

This device uses a single 3.7v Lithium 18650 FLAT TOP rechargeable battery – please note the words FLAT TOP. We recommend using quality batteries!

The Battery is inserted Positive first. Ensure that the cap is closed tightly.

NOTE:

For first usage remove the battery and remove the protective tape that is over the positive terminal.

SD Card Installation

If you wish to record video, insert a Micro SD card into the slot that is under the rubber cap.

Once you have installed the card; you need to FORMAT it via the menu.

Setup Steps

1. Install the Collar
 - a. Select the best sized Insert for your scope's eye piece.
 - b. The screws should either be at 3 or 9 o'clock for the PARD to be level.
 - c. Use Electrical Tape or similar to Protect your scope and also to give something for the collar to grip on to.
 - d. Don't over tighten the screws, they only need to be finger tight.
2. Attach the 007 to the Collar.
 - a. Pull the Locking Tab on the Left side of the 007.
 - b. Align the notch in the collar, and twist the 007 to be straight up on the collar, once centered, release the tab and gently rotate the 007 until you will hear a click or the Locking tab is engaged.
 - i. **Care should be taken during fitment of device to the adapter, do not force the engagement, a slow twist and light effort allows for an audible click which confirms engagement.**
 - c. To remove the 007, there is a release button on the left hand side, pull this and twist the 007 off the adapter – **Ensure That you PULL the Mount Release Tab to release the locking Pin.**
3. Turn the 007 on on.
4. Press the MENU Button.
5. Adjust the 007 Diopter on the eye piece so you can read the text.
6. Close the Menu.
7. Look at the rifle scope reticle.
8. Adjust the focus knob on the 007 until the reticle is in focus.
9. Ensure that 007 is level with the Reticle, adjust the collar if needed.
10. Now adjust the Parallax on your scope to bring objects in to focus.
11. DONE.

Once the 007 is setup, you will only use the Parallax and Zoom controls on your DAY SCOPE – the focus knob and dioptre on the 007 aren't moved. If the Reticle is out of focus, correct this with the focus knob under the 007.

That's it; when you remove the 007 from the scope, and replace it that's all you will do, if you move it to another rifles cope you will probably have to move the focus knob to suit that scope – thats all.

Watch the Video on Setting up the 007 - Go to our website and find the video under the Support Tab.

Custom Inserts

If the included inserts won't fit your scope or you want a perfect fit – we can make a specific insert for you – please see our website for details .

LRF Laser Rangefinder

Distance

The distance that you can range is very much dependant on the conditions at the time – even big brand binoculars L or S etc who say their (Normal Binoculars) are rated to 3200 yards on highly reflective targets, very quickly point out that you are down to 2020 yards on trees and 1310 yards on game.

The 007 SP is rated to 1000m on highly reflective targets.

Factors that affect ranging colour, Angle to Lens, Large Size, Sunlight, Atmospheric Conditions, and the object itself.

Noise

You may hear a dit dit noise when the Laser Rangefinder is active – this only occurs when the LRF is on.

This is caused by the LRF unit inside the device and the body being lightweight and very compact – we don't have a large bump out the side interfering with the use and portability of the unit which allows for more space for shielding.

From the eye piece you can may hear it and the noise doesn't go very far either so its not going to disturb something.

The benefits of the small compact lightweight device with a LRF far outweigh this.

ALL devices have been personally tested by us in Australia or New Zealand before they are sent out – the noise level isn't an issue to either its use or a warranty issue.

How to move the Range Finder Aiming Box (LRF Models Only)

Do this in the evening or at night and in night mode – as you will see the actual laser beam, you can then move the aiming box to exactly match the actual laser beam flash.

1. Press Menu button to open the Menu.
2. Long press the LRF button (the XY axis appears).
3. Move the Box using the Buttons as depicted in the picture below, press the OK button to save the new aiming box position.
4. Test the scope with the LRF at various distances and if necessary, repeat the above 3 steps to get the aiming box as precise as possible.

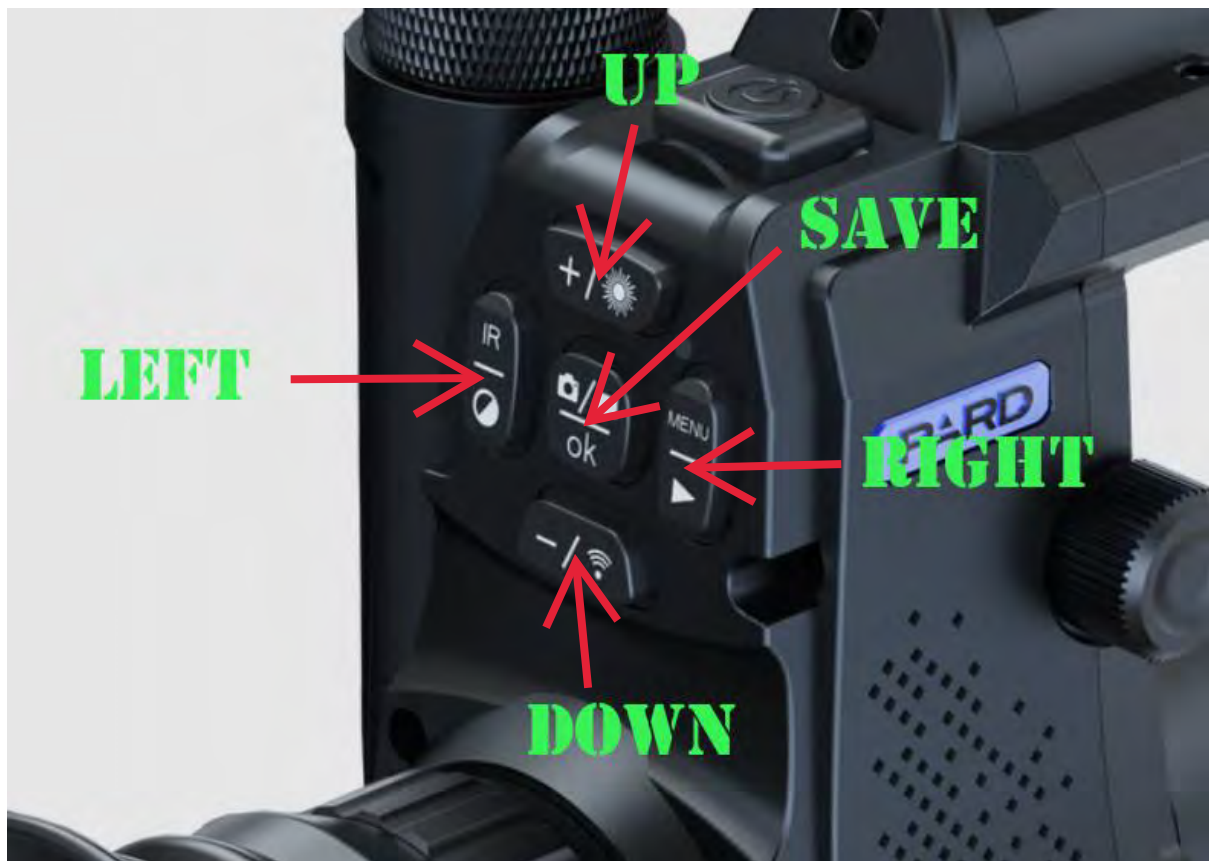

Trouble Shooting

I can see circles in the scope.

If you see something like the below image, that's actually the laser itself.



The IR Torch is focused really tightly that you can see the laser itself.

What to Do:

Simply reduce the amount of Spot/Zoom you have on the IR torch, by pushing it in slightly.

The Red Laser isn't working

Just use the default settings in the menu – This will likely re-activate it.

At close ranges the screen appears all white

This is the IR and its too bright for the 007 – its set for longer ranges to give you the range, but really close, say a tree near you etc this can occur.

You can adjust the sensitivity of the 007 in the Exposure Menu – you can adjust it up and down – simply do it while looking at something at that range and adjust it to suit – remember that if you want to shoot longer ranges again you may need to adjust it back.